

# A901C-W 电磁执行器（配 P10 泵）安装说明

步骤 1、拆开小盖板

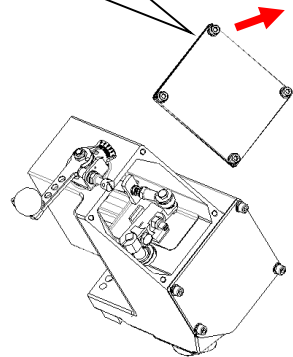

图一

步骤 2、拧松六角螺栓

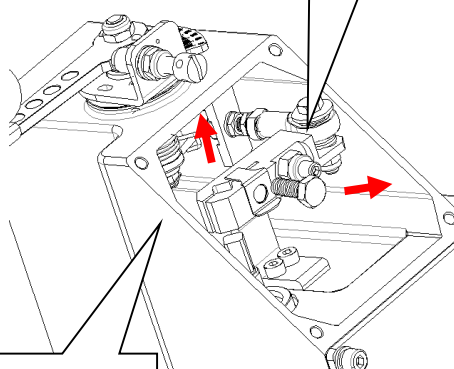

图二

步骤 4、拿出卸下的摆臂组件

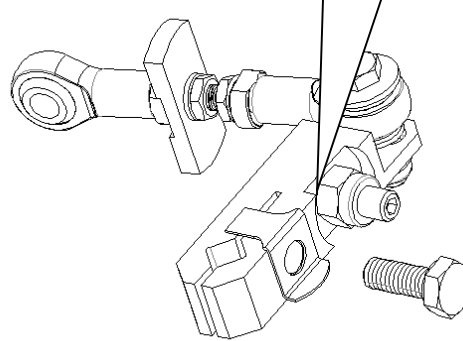

图三

步骤 5、把摆臂组件与油泵齿条连接固定好

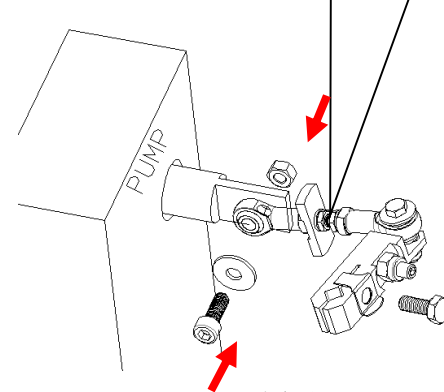

图四

步骤 3、往外拉，卸下摆臂组件

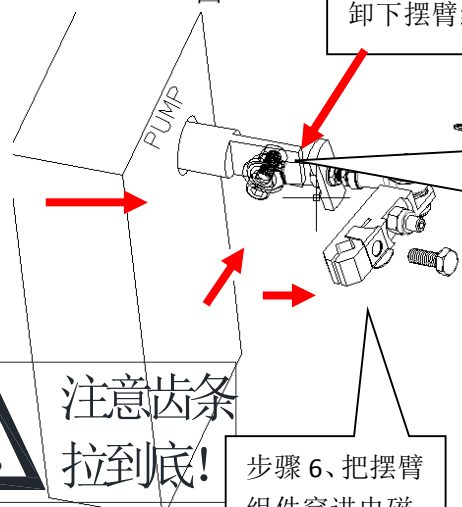

步骤 7、锁紧螺栓螺母，拉紧摆臂组件，保证油泵齿条往外拉到底

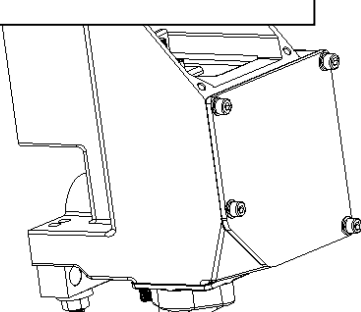

图五

步骤 6、把摆臂组件穿进电磁执行器内

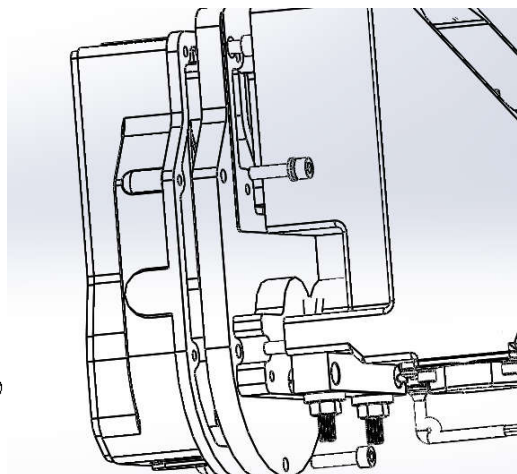

图六

步骤 8、将执行器对正孔位，安装到油泵中间体上，紧固相关连接螺栓。

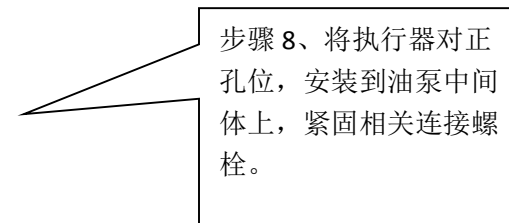

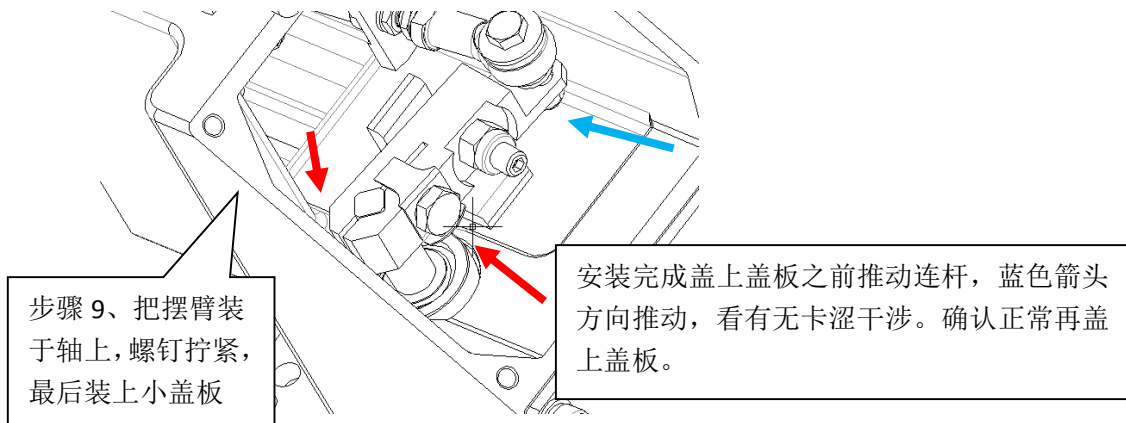

图七

# A901C-W electromagnetic actuator (with P10 pump) installation instructions

Step 1, open the small cover

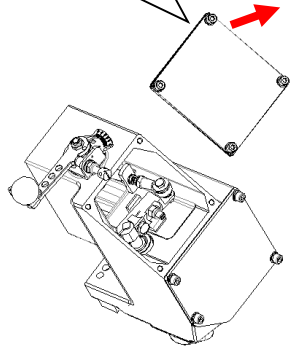

Figure 1

Step 2, loosen the Hexagon bolt

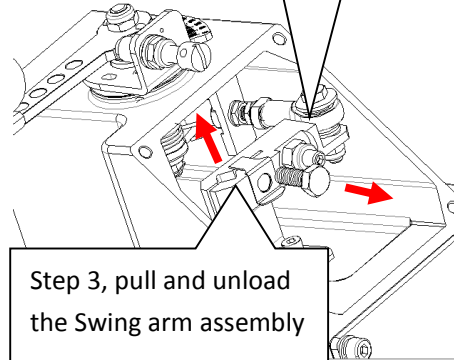

Figure 2

Step 3, pull and unload the Swing arm assembly

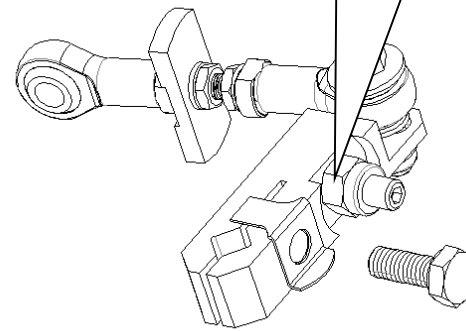

Figure 3

Step 5, the swing arm assembly is connected with the oil pump rack

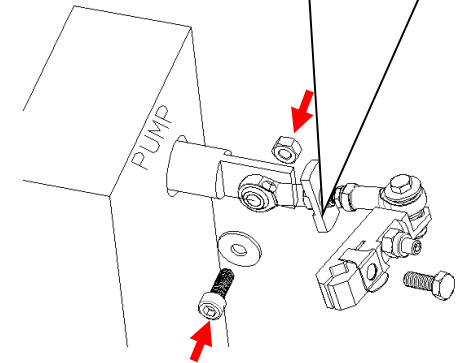
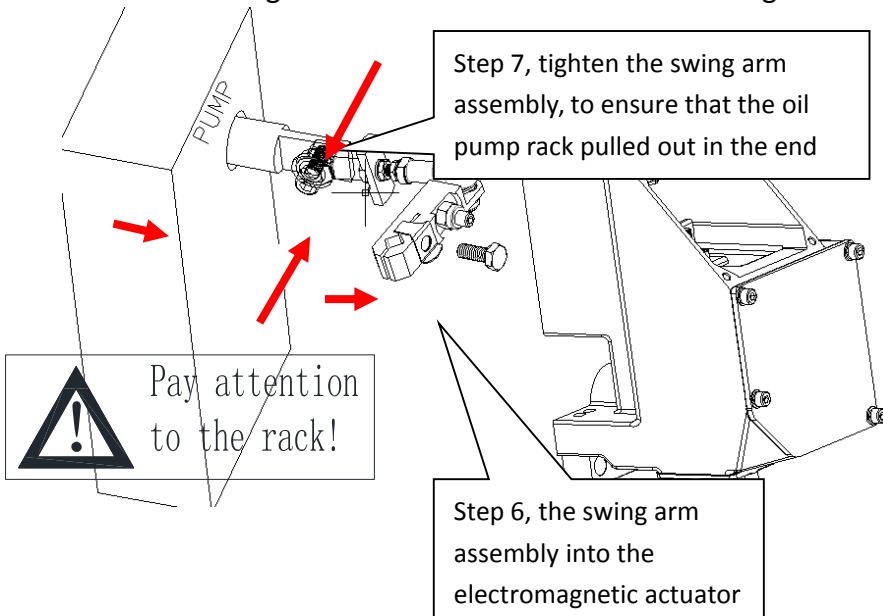

Figure 4

Step 7, tighten the swing arm assembly, to ensure that the oil pump rack pulled out in the end



Step 6, the swing arm assembly into the electromagnetic actuator

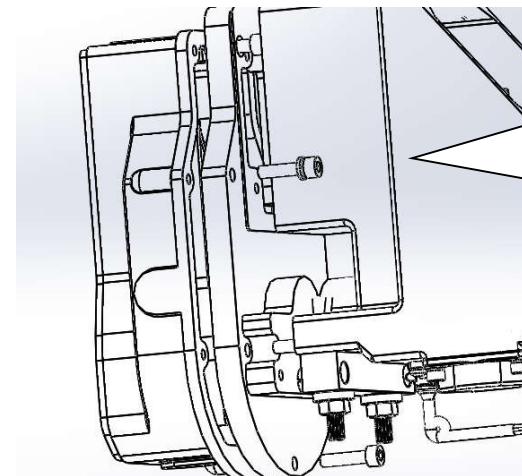

Figure 6

Step 8. Install the actuator to the positive hole position and install to the intermediate body of the oil pump, fastening the relevant connecting bolts.

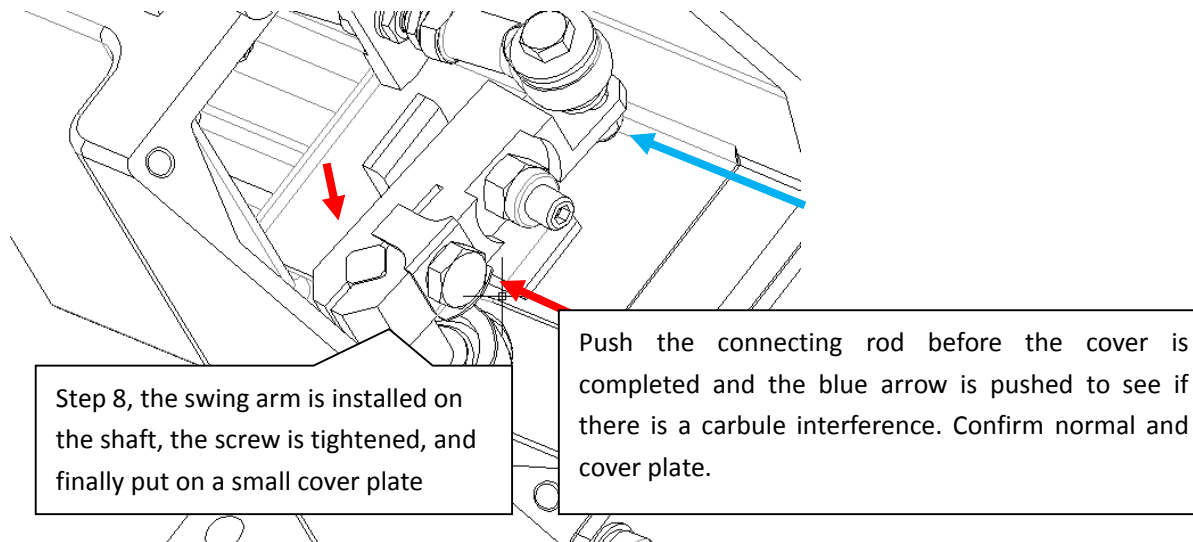

Figure 7